

4400

SERIES



Hose not included  
Tubular Base sold separately

### Non-Pivot Reels

Built to industrial strength standards, the 4400 series bolt-on reels provide years of leak-free operation and exceptional performance under rigorous conditions. Plus, with a variety of mounting options, these are the most versatile hose reels on the market!

#### Technical Specifications

All 4400 series reels are rated at 5000 PSI and 325° F and have a 2 year warranty.

#### Model 4413

3/8" Capacity .....100 ft.  
1/2" Capacity .....75 ft.  
Ship Wt. ....18 lbs.

#### Model 4416

3/8" Capacity .....200 ft.  
1/2" Capacity .....150 ft.  
Ship Wt. ....22 lbs.

*NOTE: Reel capacities may vary depending on hose brand and style.*

#### Steel Pipe Axle

Featuring schedule-80 steel pipe within the 1-1/4" tubular axle, this rugged design is ideally suited for industrial applications.



#### Exclusive Bolt-On Design

Rapid Reel's innovative mounting system allows each 4400 series reel the ability to be bolted to a variety of mounting options with ease. See back page for more details.

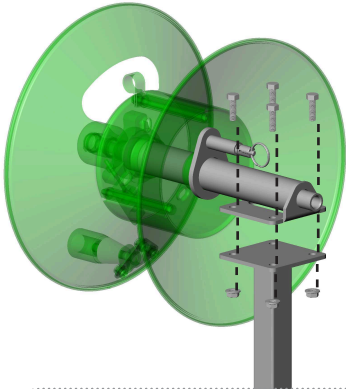

#### STANDARD FEATURES

*Continued Next Page*

##### All Metal Construction

High grade flat and tubular metal is formed to precise tolerances for long-lasting results. Rapid Reel hose reels are built for those who appreciate great quality.

##### Cam-Lever Brake

Keeps the hose from unspooling while reel is in use. Turns off and on with the flick of a finger. Durable material will last a lifetime.



##### Spring Reel Lock

Located on the back of the reel, this lock keeps the reel from unwinding when not in use. Spring action pin provides easy engagement with simple pull-n'-turn motion.



##### Solid Surface Drum

An all metal drum provides a smooth, circular surface for the hose to wrap around. Having no sharp corners, bends or openings extends hose life.

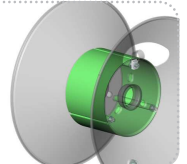

##### Smooth Spin Bushings

Pressed between the reel and axle, these durable, long-life bushings will keep the reel spinning smoothly for years. Completely maintenance-free.

